

STARSYS™ *Enclosed Units with Wire Shelves*



**SINGLE WIDE -
STATIONARY UNIT**



**DOUBLE WIDE -
MOBILE UNIT**

Shelf Weight Capacities:

Full Extension Shelves:

Single Wide = 60 lbs. (27 kg)

Double Wide = 125 lbs. (57 kg)

Fixed qwikSLOT™ Shelves:

Single Wide = 150 lbs. (68 kg)

Double Wide = 300 lbs. (136 kg)



InterMetro Industries Corporation
North Washington Street, Wilkes-Barre, PA USA 18705
For Product Information Call: **1-800-992-1776**
Visit Our Web Site: **www.metro.com**

INSTRUCTIONS FOR USE

*For Enclosed Shells with Active
and qwikSLOT™ Wire Shelves*

Enclosed Units with Wire Shelves

INSTRUCTIONS FOR USE

Full Extension Shelving

NOTE: Do not place active levels above 48" (1219mm) from floor.

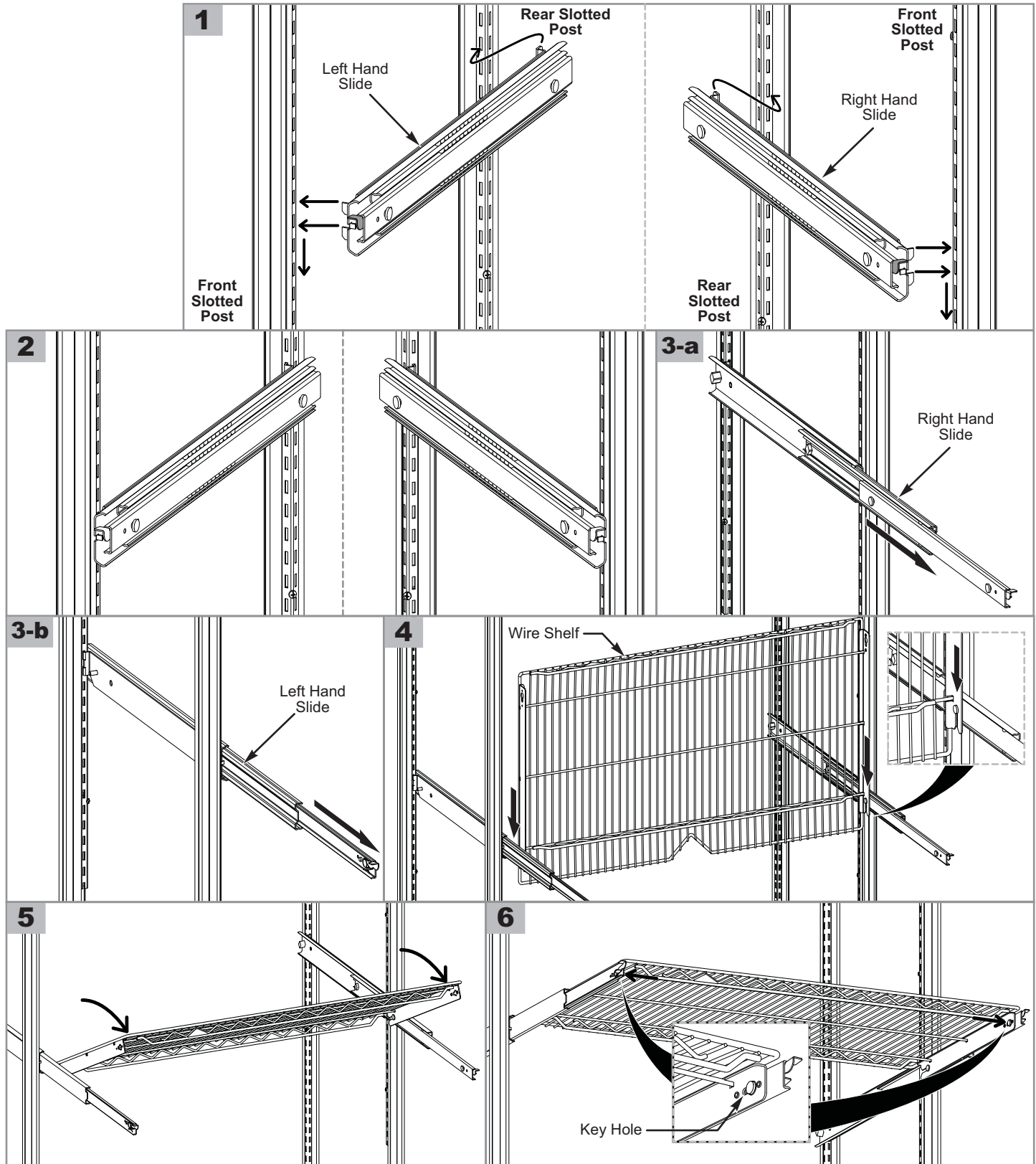

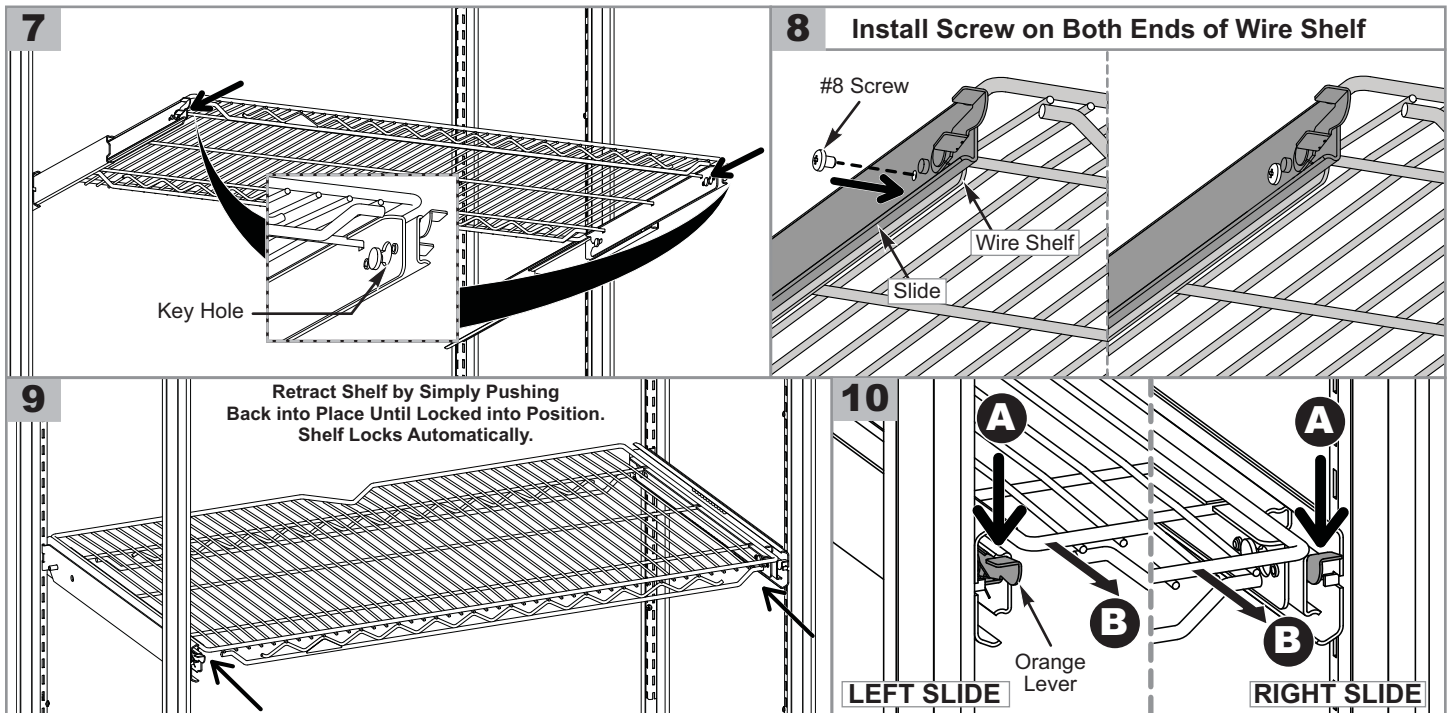

NOTICE

In accordance with International Standard IEC 601-1 (ANSI/UL 2601), **NORMAL USE** is defined as only one Drawer or Shelf of the EQUIPMENT opened at any one time; excluding transport, where all Drawers or Shelves must be closed and their locking mechanisms engaged.

INSTRUCTIONS FOR USE

Fixed qwikSLOT™ Shelf

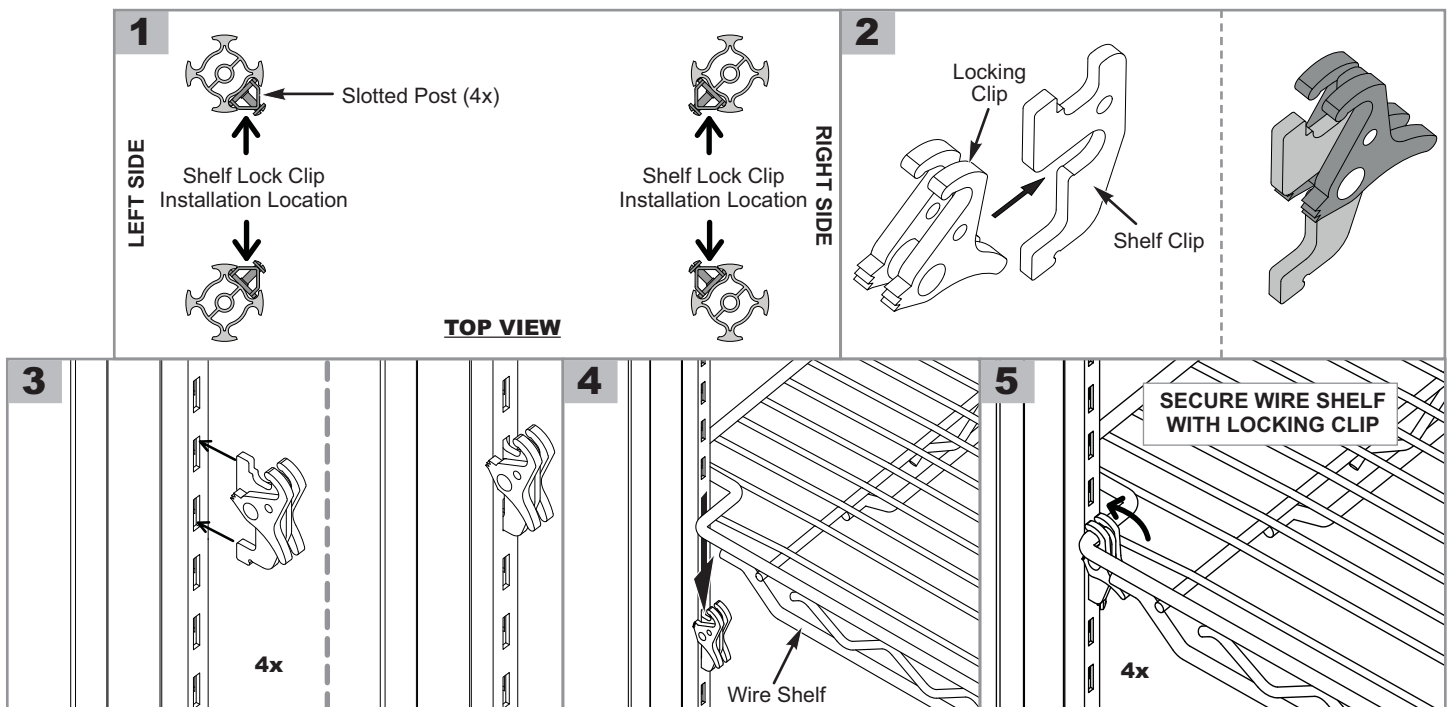

Enclosed Units with Wire Shelves

OPTIONAL ACCESSORIES

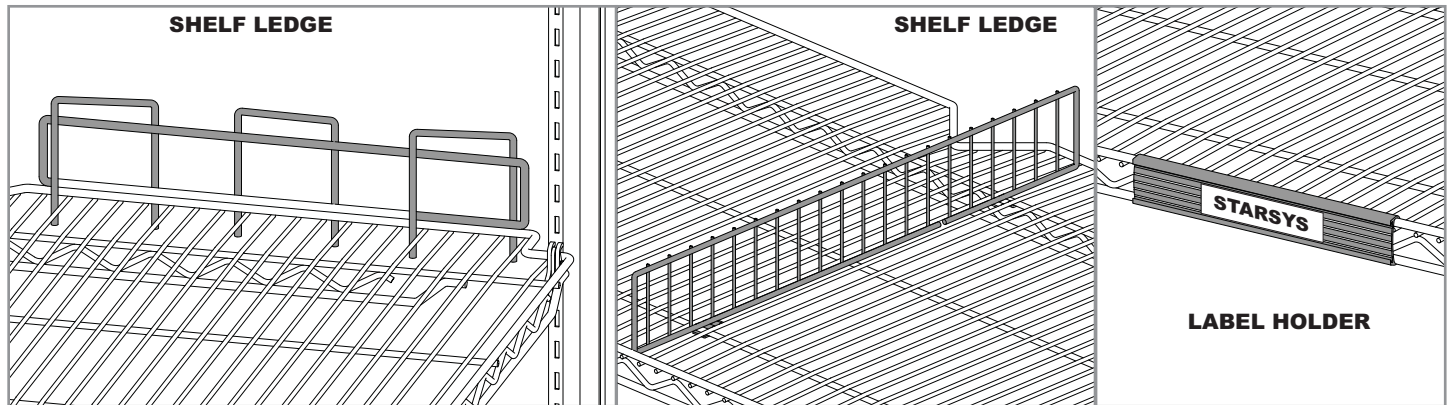

CLEANING INSTRUCTIONS

Starsys cart bodies and some accessories are constructed of durable advance composite of polymers. A soft cloth, mild soap and water solution can be used to clean lightly soiled surfaces. After cleaning, wipe dry with a clean soft cloth.

For heavily soiled areas, a soft brush and solvent or emulsionbased cleaners may be employed. Always insure that the cleaner is recommended for use on plastics and follow any special instructions from the manufacturer.

The use of abrasive cleaners is NOT recommended.

Please read the instructions for recommendations on correct cleaning materials and procedures.

RECOMMENDED TYPES OF CLEANING PRODUCTS

NOTE: This list is by no means complete. The listed products are only ones that have been proven effective in cleaning the cart body, drawers and accessories. It is not our intention to promote particular brands.

CLEANER BASE	DESCRIPTION	PRODUCT EXAMPLES
Phenol	Liquid detergent, disinfectant, deodorizer	Amphyl
Chlorine	Liquid disinfectant	Bleach
Alkaline	Liquid detergent Liquid detergent	Conquer II Prime
Alcohol	Antiseptic sterilizer	Isopropyl Alcohol
Iodophor	Liquid germicide detergent	Accord
Quaternary Ammonia Compound	Liquid detergent, disinfectant Liquid detergent, disinfectant Liquid detergent, germicide, deodorizer Foam cleaner, disinfectant Liquid detergent, disinfectant	FSD-4 Spartec Micro-Quat Spra-Temp Lysol 256

*Save this document for future application, load rating and/or safety reference.



InterMetro Industries Corporation
North Washington Street, Wilkes-Barre, PA USA 18705
For Product Information Call: **1-800-992-1776**
Visit Our Web Site: **www.metro.com**

L01-262 Rev.A
01/2015

Information and specifications are subject to change without notice. Please confirm at time of order.