

StarsysXD Assembly



Cart Load Capacities:

Adjustable qwikSLOT™ Shelves:
 Single Wide = 300 lbs. (136 kg)
 Double Wide = 600 lbs. (272 kg)
 Triple Wide = 600 lbs. (272 kg)

Shelf Weight Capacities:

Adjustable qwikSLOT™ Shelves:
 Single Wide = 100 lbs. (45 kg)
 Double Wide = 200 lbs. (91 kg)

For Enclosed Shells and Angular Adjustable qwikSLOT™ Wire Shelves

DESCRIPTION

StarsysXD Assembly – This instruction sheet covers installation procedure, user guide for CompX Regulator, RP parts, RP kit installation, unlock/lock using key override and Electronic PIN Lock in double and single door.

INSTRUCTIONS FOR USE

Adjustable qwikSLOT™ Shelf

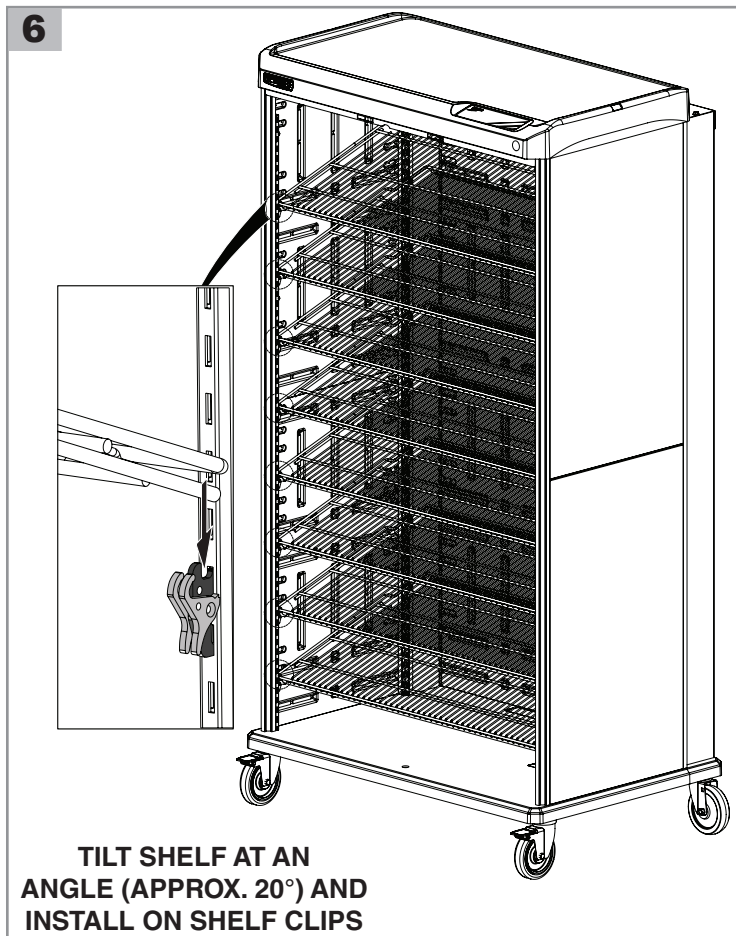
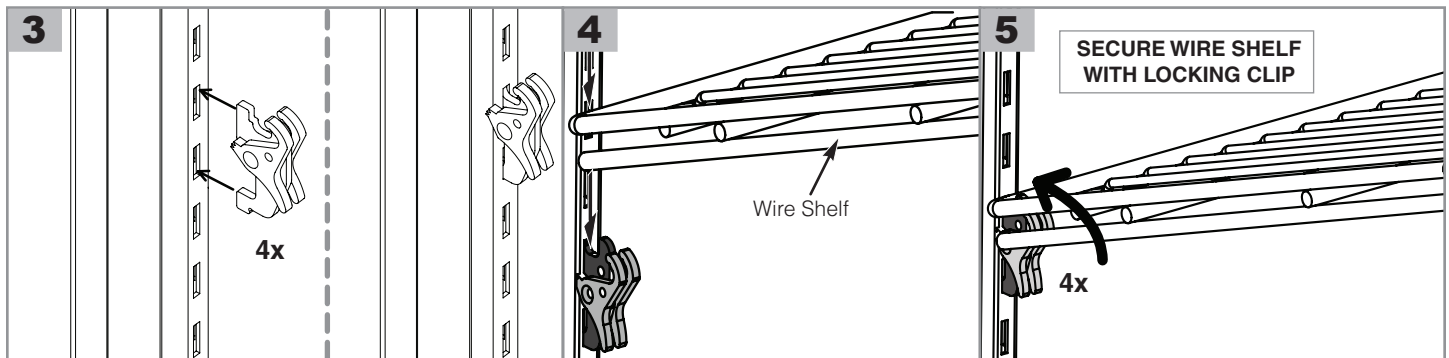
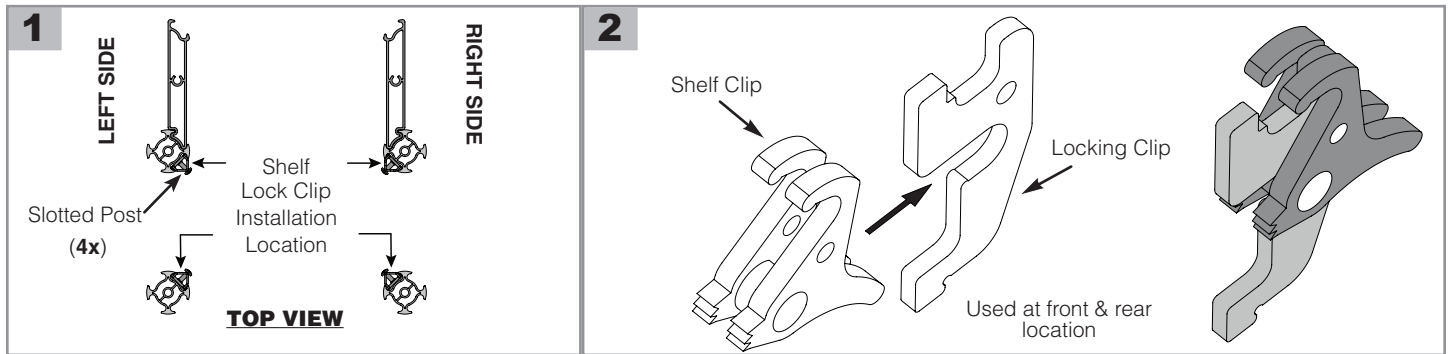

REPLACEMENT PARTS

Item	Part No.	Description
1	RPSXRCLOCK-D	Electronic PIN Lock Kit - Double Center Open Door
2	RPSXRCLOCK-S	Electronic PIN Lock Kit - Single
3	RPC02-224	5 Inch Poly Swivel Caster
4	RPC02-257	5 Inch Poly Swivel Caster with Toe Brake
5	RPSXRDRPL-TP	LH Drawer Pulls; Taupe
6	RPSXRDRPR-TP	RH Drawer Pulls; Taupe
7	RPSXRDRPL-BL	LH Drawer Pulls; Slate Blue
8	RPSXRDRPR-BL	RH Drawer Pulls; Slate Blue
9	RPSXR270HNG-2	270° Door Hinge (QTY: 2)
10	RPSXRQS64-4-2B	Starsys, Accessories, Kits, Q-Slot Insert Kits
11	RPQSCLIPKIT	C09-072 (QTY: 4) AND QS-CLIP (QTY: 4)
12	RPC14-388	RegulatoR Electronic PIN Lock
13	RPC14-389	Plastic Bolt Sub-Assy

CompX[®] Regulator[®] USER GUIDE

The Regulator is used for locking cabinet doors and drawers. It can mount to cabinet doors with a material thickness of 1/32" to 1-7/16". Powered by 2-AAA batteries (included), Regulator operates using a 4 to 8 digit code. Operation is simple: type a valid code and press ENTER. Then just turn the lever to the locked or unlocked position.

Regulator is easy to install, and offers:

- Programmable user and supervisor codes,
- Programmable modes of operation,
- Programmable reset features,
- Regulator is intended for interior use only,
- **Operating Temperature:** 50°F – 120°F (10°C – 48°C).

NOTE: It is strongly recommended that batteries be replaced on an annual basis. In the event the batteries should die, they can be replaced via the external battery compartment.

Contents – Self Lock Version:

- Self Locking Regulator Lock assembly featuring SlamCAM,
- 2 AAA alkaline batteries,
- SlamCAM spacer discs,
- Mounting hardware.

Each lock contains 2 green stickers that are needed for resetting Regulator. In the event Regulator needs to be reset, one green sticker is placed on the back of the device. The remaining green sticker should be saved in a safe and secure location for future reference. (See "**Reset Instructions**" on page #5.)

Care and Cleaning

To clean the Regulator surface, apply non-acid based cleaner to a clean cotton cloth; do not spray cleaner directly on the Regulator. Wipe down keypad and its respective housing surfaces of excess cleaner.

Powering Up and Battery Installation

CompX[®] Regulator[®] is shipped with two AAA batteries. While Regulator features a low battery indicator, annual battery replacement is recommended.

NOTE: Mixing batteries of different chemistries could damage the Regulator resulting in lock failure.

To power up Regulator, remove the red tag. Lock is now ready for use. A T-15 pin in head Torx[®] (6-lobe) (Not Included) will be required to remove the battery cover.

To change batteries:

1. Loosen the retaining screw.
2. Remove battery cover.
3. Press CLEAR "5" times.
4. Insert new batteries as shown in the illustration.
5. Reinstall battery cover, tighten retaining screw.

Programming – Introduction

CompX[®] Regulator[®] is easy to program and operate.

Type the user code (factory default 1234) and press ENTER to lock or unlock the cabinet.

The supervisor can change operating codes, modes and restore lock settings.

While Regulator is easy to program, we highly recommend reading the complete programming instructions prior to making any changes. Remember to keep track of any programming changes.

Button locations, indicator lights and knob referenced in the programming instructions are shown below:





Follow the directions below to operate (unlock and lock) the standard Self Lock version of Regulator:

- type a valid code, press **ENTER**,
- rotate knob clockwise 90°,
- hold knob until door is open,
- release knob, Regulator knob will return to the locked position. Door can be closed at any time.

Regulator Programming Mode

To enter programming mode you must know the supervisor code. The default supervisor code is **12345**. Once in programming mode, multiple changes can be made prior to exiting programming.

NOTE: There is a 10 second programming time limit between each step. If Regulator times out or an error is made, programming will end and you will need to enter programming mode again.

1. Lock must be in the locked position prior to entering programming mode.
2. Type supervisor code and press **ENTER**.
3. Rotate the knob to the **unlocked** position and press and hold **ENTER** for "3 seconds" (yellow indicator light will illuminate).
 - If product is Self Lock with the SlamCAM feature you can now let go of the knob.
4. With the yellow indicator light illuminated, programming can begin.

Changing the User Code

To change the user code, refer "**Regulator Programming Mode**" to enter programming mode. The factory default user code is **1234** (User codes must be 4 to 8 digits in length.)

NOTE: There is a 10 second programming time limit between each step. If Regulator times out or an error is made, programming will end and you will need to enter programming mode again.

1. Place Regulator into programming mode (See "**Regulator Programming Mode**").
2. Press "1" and then press **ENTER**.
3. Type the current user code and press **ENTER**.

4. Type the new user code and press **ENTER**.
 5. Retype the new user code and press **ENTER**.
 6. If successful, the **green** indicator light will illuminate for 1 second.
- Continue programming or **press 9** and then **ENTER** to exit programming.

NOTE: Self Lock Regulator operates with a fixed code. **Changing the Supervisor Code**

To change the supervisor code, refer "**Regulator Programming Mode**" to enter programming mode. The factory default supervisor code is **12345** (supervisor codes must be 4 to 8 digits in length.)

NOTE: There is a 10 second programming time limit between each step. If Regulator times out or an error is made, programming will end and you will need to enter programming mode again.

1. Place Regulator into programming mode (See "**Regulator Programming Mode**").
 2. Press "**2**" and then press **ENTER**.
 3. Type the current supervisor code and press **ENTER**.
 4. Type the new supervisor code and press **ENTER**.
 5. Retype the new supervisor code and press **ENTER**.
 6. If successful, the **green** indicator light will illuminate for 1 second.
- Continue programming or **press 9** and then **ENTER** to exit programming.

Reset Instructions

Regulator[®] features a reset code which will restore the default supervisor code and user code. Regulator was shipped with reset stickers; one attached to the back of the Regulator and an extra sticker that should be saved in a safe and secure location for future reference.

NOTE: To restore the factory default supervisor and user code, type the "**Reset Code**" assigned to the Regulator and press **ENTER**.

Programming Security Timeout ON / Security Timeout OFF

WARNING: Security Timeout ON will disable the Regulator from use for 5 minutes when 5 invalid attempts to unlock Regulator occur. During this time, Regulator will not unlock with either the valid user or supervisor code.

To change the Regulator to Security Timeout ON or OFF, refer "**Regulator Programming Mode**" to enter programming mode.

NOTE: There is a 10 second programming time limit between each step. If Regulator times out or an error is made, programming will end and you will need to enter programming mode again.

1. Place Regulator into programming mode (See "**Regulator Programming Mode**").
- To turn **Security Timeout ON**, type "**11**" and then press **ENTER**.

OR

- To turn **Security Timeout OFF**, type "**10**" and then press **ENTER**.
2. If successful, the **green** indicator light will illuminate for 1 second.
- Continue programming or **press 9** and then **ENTER** to exit programming.

Reset User Code to Factory Default 1234

To reset the **User Code** to the factory default **1234**, refer "**Regulator Programming Mode**" to enter programming mode.

NOTE: There is a 10 second programming time limit between each step. If Regulator times out or an error is made, programming will end and you will need to enter programming mode again.

1. Place Regulator into programming mode (See "**Regulator Programming Mode**").
2. Type "**8888**" and then press the **ENTER** button.
3. If successful, the **green** indicator light will illuminate for 1 second.

Continue programming or **press 9** and then **ENTER** to exit programming.

Add User Without Specifying Memory Slot

The **Supervisor Code** memory location is called **Slot 01** and the first **User Code** is called **Slot 02**.

- Any additional user codes reside in memory slots 03-20.
- To add a user code without specifying a memory slot (03 -20), refer "**Regulator Programming Mode**" to enter programming mode.

User codes must be 4 to 8 digits in length and **must** be different from all existing codes (including Slot 01 Supervisor & Slot 02 User codes).

StarsysXD Assembly — INSTRUCTIONS FOR USE

NOTE: There is a 10 second programming time limit between each step. If Regulator times out or an error is made, programming will end and you will need to enter programming mode again.

1. Place Regulator into programming mode (See "**Regulator Programming Mode**").
2. Press "410" and then press **ENTER**.
3. Type the new user code and press **ENTER**.
4. Retype the new user code and press **ENTER**.
5. If successful, the **yellow** indicator light will illuminate.

Continue programming or **press 9** and then **ENTER** to exit programming.

Add User to Specific Memory Slot (03 – 20)

The **Supervisor Code** memory location is called **Slot 01** and the first **User Code** is called **Slot 02**.

- Any additional user codes reside in memory slots 03-20.
- To add a user code to a specific memory slot (03 -20), refer "**Regulator Programming Mode**" to enter programming mode.

User codes must be 4 to 8 digits in length and **must** be different from all existing codes (including Slot 01 Supervisor & Slot 02 User codes).

NOTE: There is a 10 second programming time limit between each step. If Regulator times out or an error is made, programming will end and you will need to enter programming mode again.

1. Place Regulator into programming mode (See "**Regulator Programming Mode**").
2. Press "411" and then press **ENTER**.
3. Type memory slot to be added followed by **ENTER** (for memory slots 03 - 09, you must type leading "0" – e.g. "07" for slot 7).
4. Retype memory slot to be added followed by **ENTER**.
5. Type the new user code and press **ENTER**.
6. Retype the new user code and press **ENTER**.
7. If successful, the **yellow** indicator light will illuminate.

Continue programming or **press 9** and then **ENTER** to exit programming.

Delete User Without Specifying Memory Slot

The **Supervisor Code** memory location is called **Slot 01** and the first **User Code** is called **Slot 02**.

- The additional user codes reside in memory slots 03-20.
- To delete a user code without specifying a memory slot (03 -20), refer "**Regulator Programming Mode**" to enter programming mode.

NOTE: There is a 10 second programming time limit between each step. If Regulator times out or an error is made, programming will end and you will need to enter programming mode again.

1. Place Regulator into programming mode (See "**Regulator Programming Mode**").
2. Press "400" and then press **ENTER**.
3. Type the user code to be deleted and press **ENTER**.
4. Retype the user code to be deleted and press **ENTER**.
5. If successful, the **yellow** indicator light will illuminate.

Continue programming or **press 9** and then **ENTER** to exit programming.

Delete User From Specific Memory Slot (03 – 20)

The **Supervisor Code** memory location is called **Slot 01** and the first **User Code** is called **Slot 02**.

- The additional user codes reside in memory slots 03-20.
- To delete a user code from a specific memory slot (03 -20), refer "**Regulator Programming Mode**" to enter programming mode.

NOTE: There is a 10 second programming time limit between each step. If Regulator times out or an error is made, programming will end and you will need to enter programming mode again.

1. Place Regulator into programming mode (See "**Regulator Programming Mode**").
2. Press "401" and then press **ENTER**.
3. Type memory slot to be vacated followed by **ENTER** (for memory slots 03 - 09, you must type leading "0" – e.g. "07" for slot 7).
4. Retype memory slot to be vacated followed by **ENTER**.
5. If successful, the **yellow** indicator light will illuminate.

Continue programming or **press 9** and then **ENTER** to exit programming.

DOUBLE DOOR - RP KIT INSTALLATION

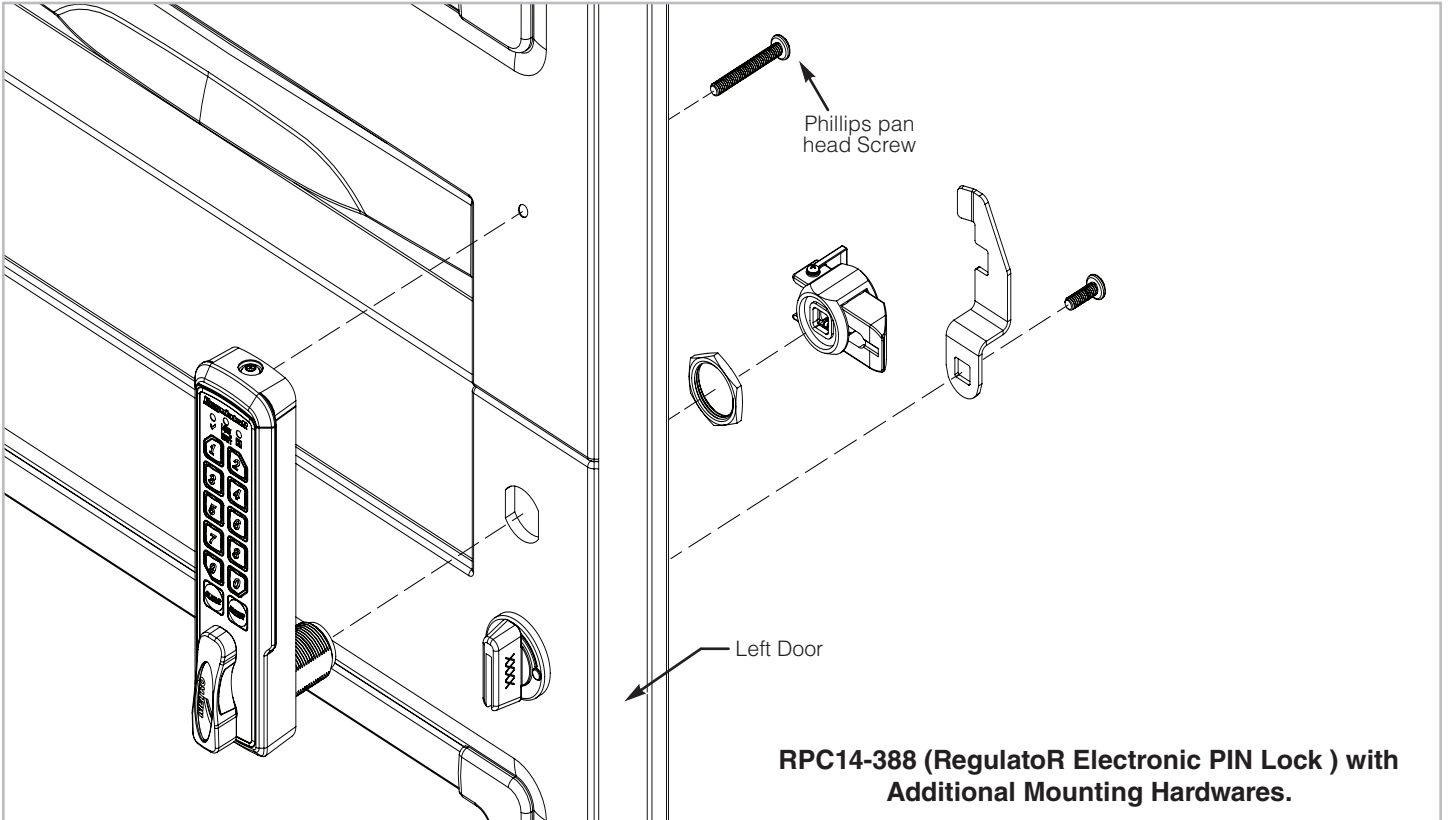

SINGLE DOOR - RP KIT INSTALLATION

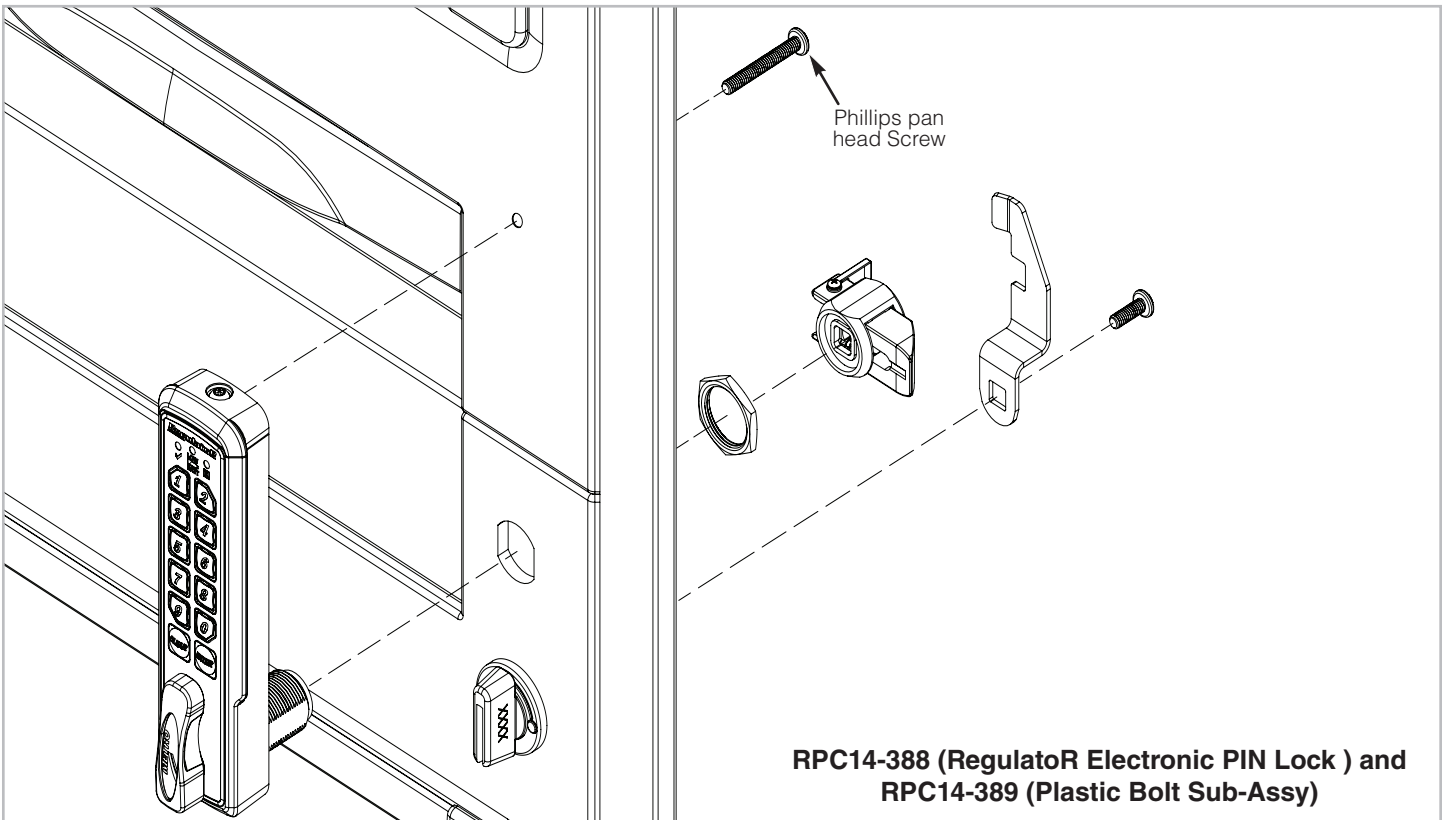

SINGLE WIDE UNLOCK / LOCK USING KEY OVERRIDE AND ELECTRONIC PIN LOCK

Unlock using Key Override

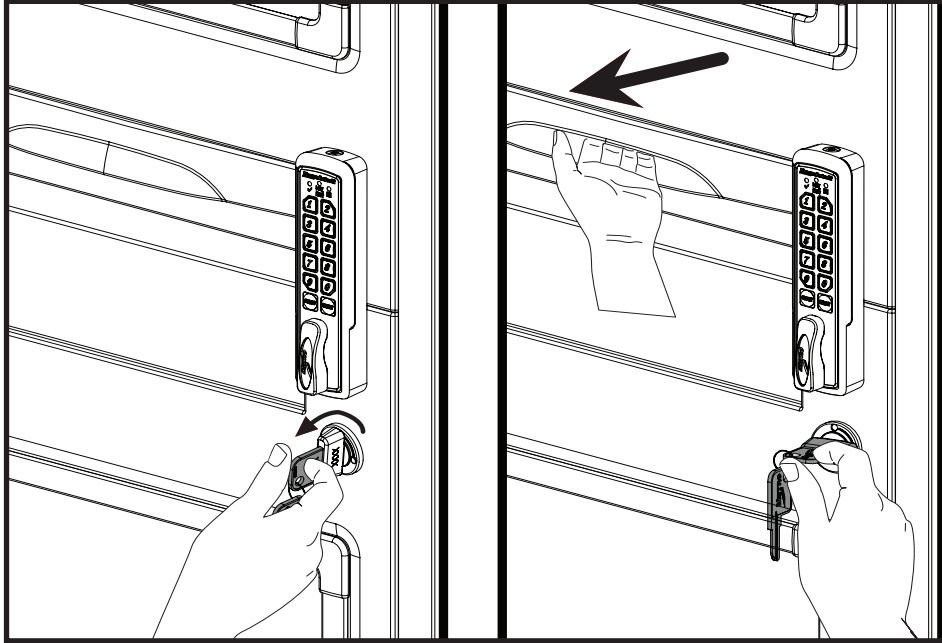

To unlock the cabinet, using key override:

1. Rotate the key in counter clock-wise direction, and hold the key in that position.
2. To open, pull the cabinet door.

Lock using Key Override

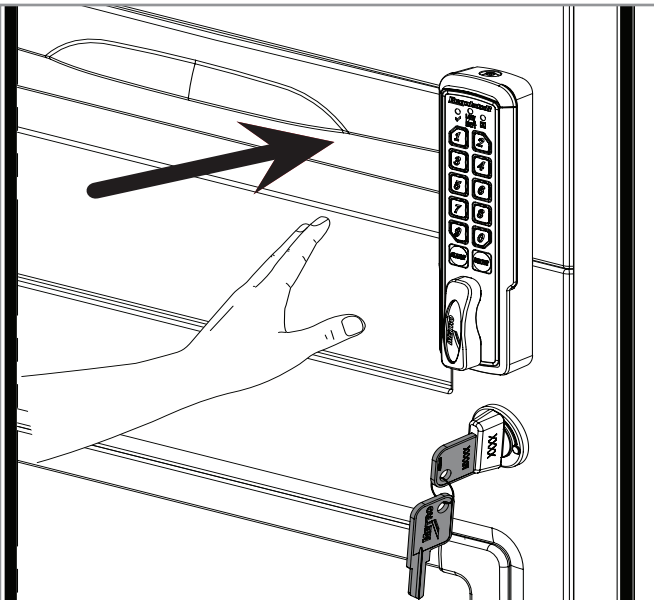

To lock the cabinet, using key override:

1. To close, push the cabinet door.
2. The door gets lock automatically.

NOTE: Remove key from key override when not in use.

Unlock using Electronic PIN Lock

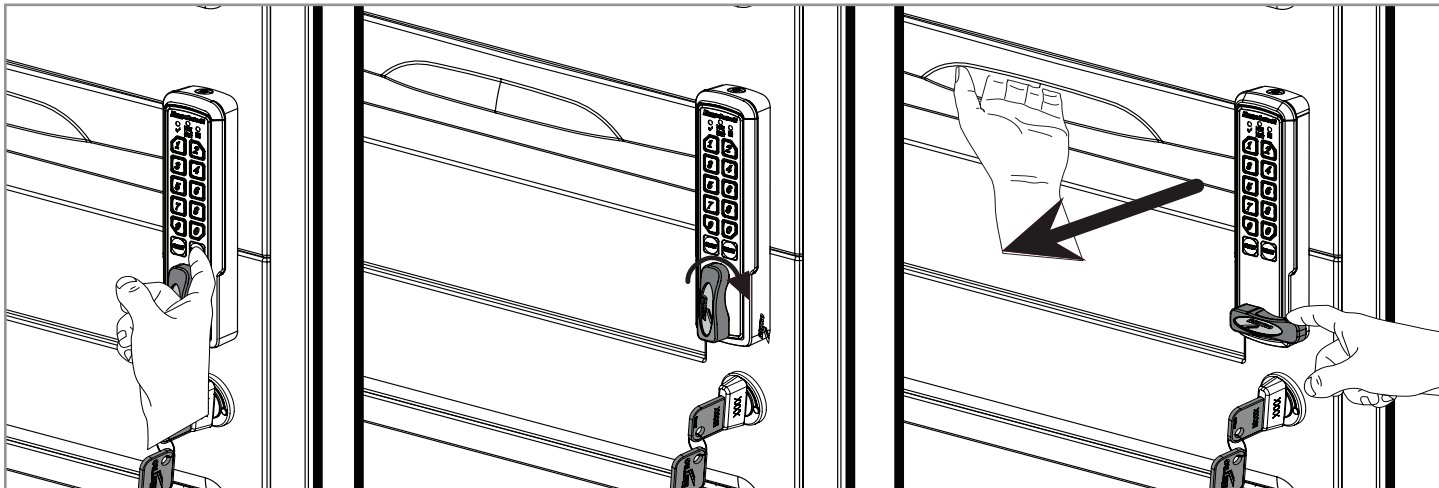

To unlock the cabinet, using Electronic PIN Lock:

1. Press the user code, and then press ENTER.
2. Rotate the knob to 90° in clockwise direction, and hold the knob in that position.
3. To open, pull the cabinet door.

Lock using Electronic PIN Lock

To lock the cabinet, using Electronic PIN Lock:

1. To close, push the cabinet door.
2. The door gets lock automatically.

DOUBLE WIDE UNLOCK / LOCK USING KEY OVERRIDE AND ELECTRONIC PIN LOCK

Unlock using Key Override

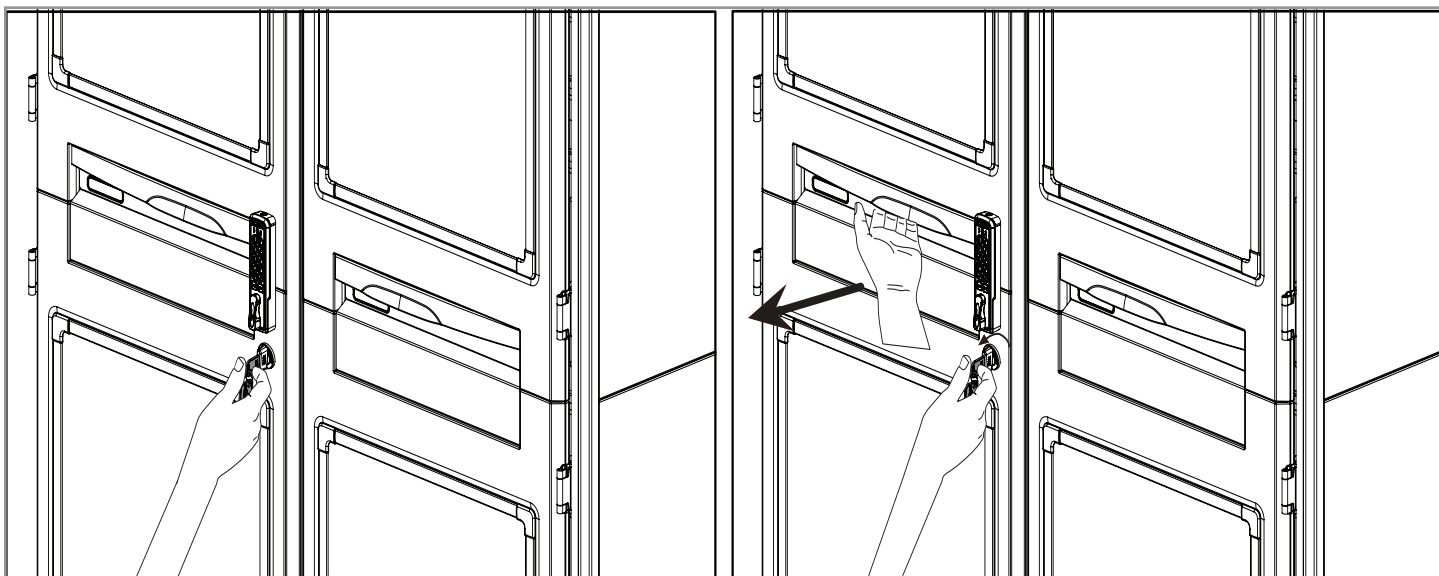

To unlock the cabinet, using key override:

1. Rotate the key in counter clock-wise direction, and hold the key in that position.
2. To open, pull the left cabinet door.

Lock using Key Override

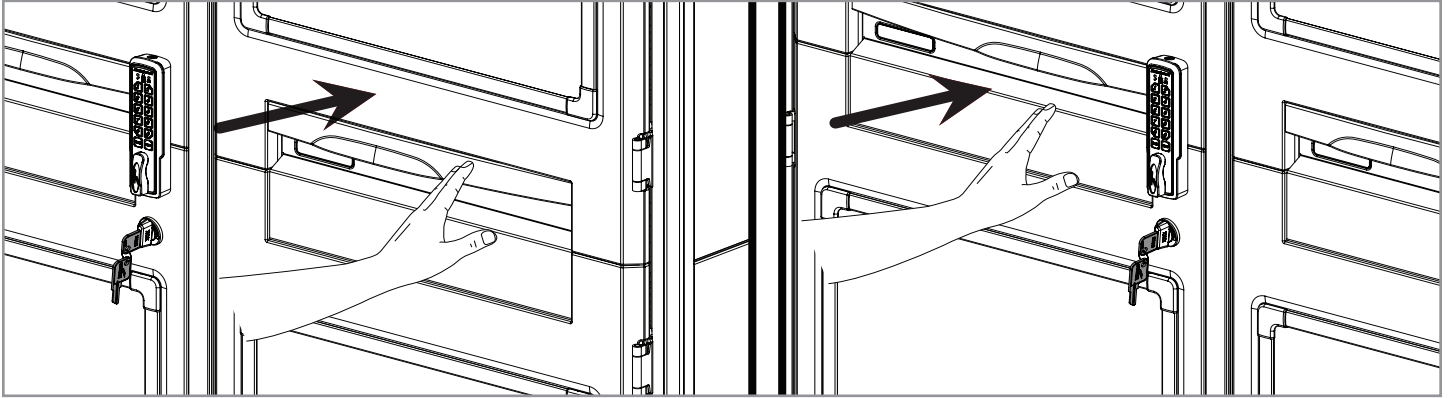

To lock the cabinet, using key override:

1. To close, first push the right cabinet door and then the left cabinet door.
2. The door gets lock automatically.

NOTE: Remove key from key override when not in use.

Unlock using Electronic PIN Lock

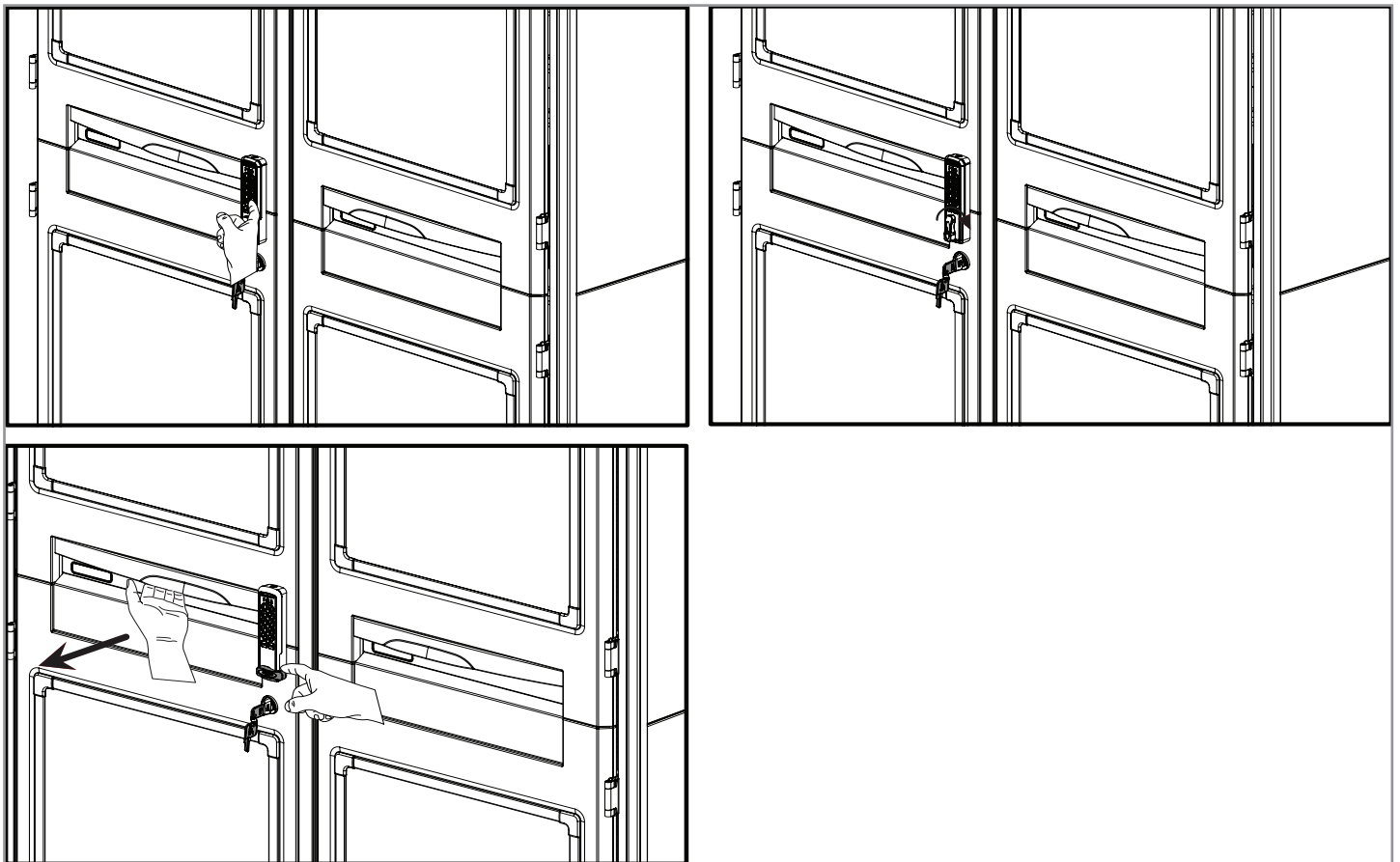

To unlock the cabinet, using Electronic PIN Lock:

1. Press the user code, and then press ENTER.
2. Rotate the knob to 90° in clockwise direction, and hold the knob in that position.
3. To open, pull the left cabinet door.

To lock the cabinet, using Electronic PIN Lock:

1. To close, first push the right cabinet door and then the left cabinet door.
2. The door gets lock automatically.

PAGE INTENTIONALLY LEFT BLANK

* Save this document for future application, load rating and/or safety reference.

© 2019 InterMetro Industries Corporation, Wilkes-Barre, PA 18705
L01-625 REV E 09/20



We put space to work.

an Ali Group Company



The Spirit of Excellence